

2017 Canadian Society for Ecology and Evolution Meeting

with the Canadian Section, The Wildlife Society

May 7–10th Victoria, British Columbia

Victoria Conference Centre & Royal BC Museum



ROYAL **BC** MUSEUM

LEVEL ONE | 23,500ft²
2,183m²

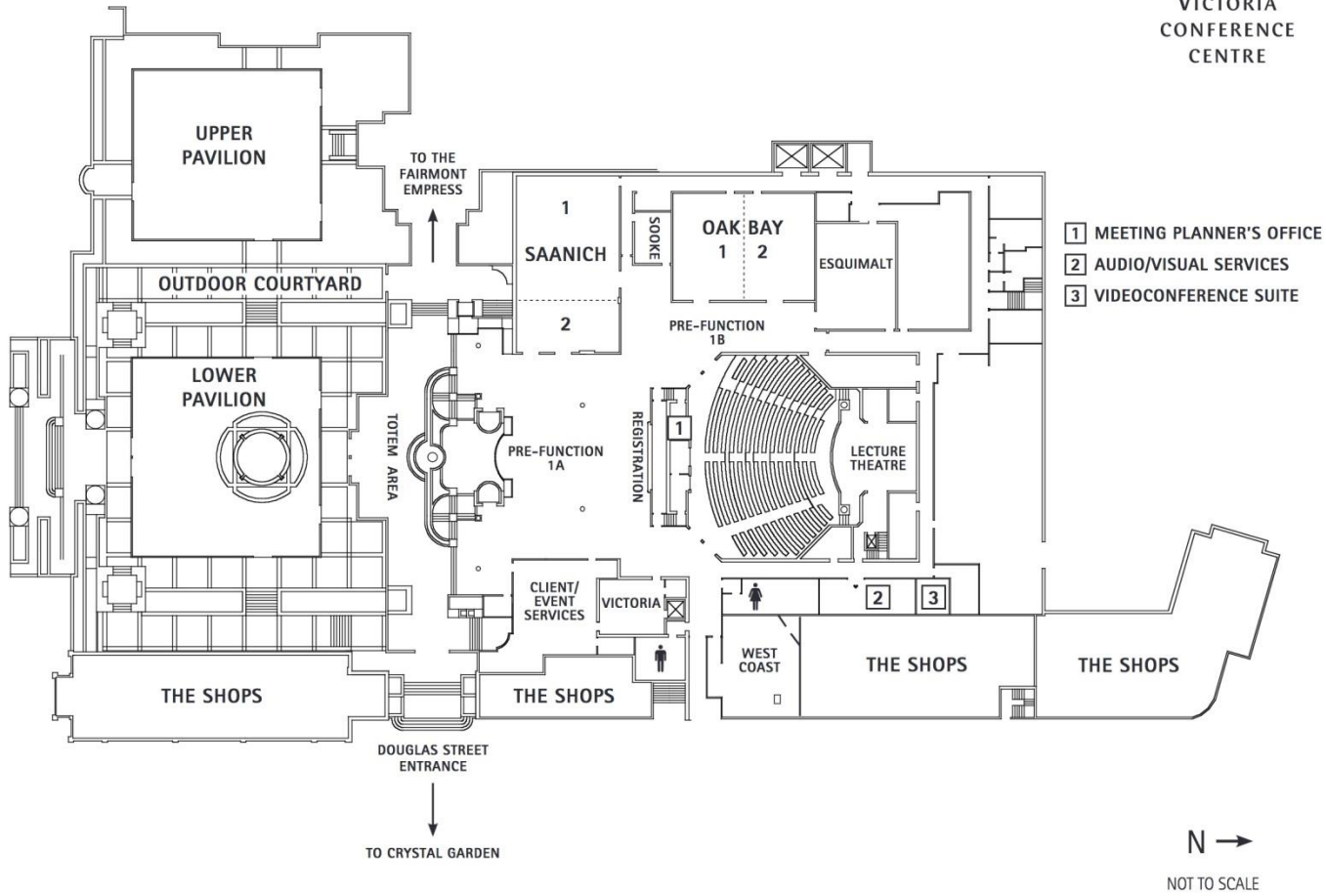

VICTORIA
CONFERENCE
CENTRE

LEVEL TWO | 24,500ft²
2,276m²

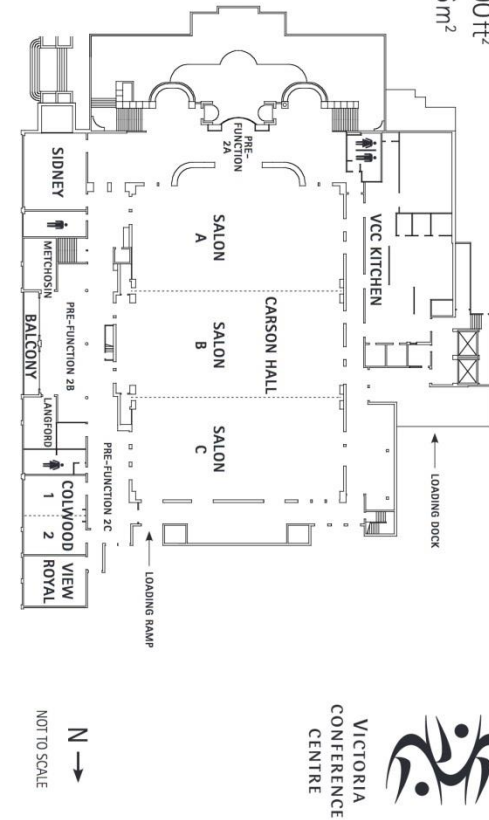

VICTORIA
CONFERENCE
CENTRE

Sun

Room:

Victoria Conference Centre

Theatre

Saanich

Oak Bay

Newcombe Hall RBCM

08:00

08:00 - 11:00
Science communication 101

11:00

11:00 - 15:00
Symposium for Women
Entering Ecology &
Evolution Today (SWEET)

14:00

14:00 - 20:30
Registration,
coffee and snacks available
Reg. desk, Level 1

15:00

15:00 - 18:00
Maps and Spatial Data with
R

15:00 - 18:00
Mental Health in Academia

18:00

20:00

18:00 - 20:00
Welcome &
CSEE President's Award talk
(Dr. Sally Otto)

20:30

Mon	Ecological and Evolutionary Dynamics in Fluctuating Environments Symposium	Uncertainty in Ecology and Conservation Symposium	Stickleback ecology and evolution	Accelerating urban ecology in Canada: Identifying current research approaches, gaps, and needs in Canadian cities Symposium	Host-associated microbes: from protective microbes to pathogens Symposium Microbial ecology	Phylogenetics	Museum collections symposium
Room:	Theatre	Saanich	Oak Bay 1	Oak Bay 2	Esquimalt	West Coast	Newcombe RBCM
08:00	Seasonality, climate change, and consumer-resource dynamics, John Fryxell	Uncertainty and the relationship between human and environmental well-being, Shripad Tuljapurkar	Convergent evolution of a color vision gene facilitates adaptive radiation of threespine stickleback into different light environments, David A. Marques	Linking urban landscape structure to ecosystem service provision, Matthew Mitchell	Rapid evolution of microbe-mediated protection, Kayla King	Introduced common reed (<i>Phragmites australis</i>) in western Canada: A future problem or not?, Geraldine A. Allen	Welcome, Kelly Sendall
08:15	Hot and cold, wet and dry: The role of season in structuring aquatic food webs, Bailey McMeans		Heterozygosity and asymmetry in threespine stickleback, Matthew Morris	What can human-wildlife encounters in the city tell us about urban ecology?, Justin Podur	Tree-ectomycorrhizal symbioses: Does diversity confer function?, Holly Moeller	A comparative analysis of mitochondrial DNA in dioecious (<i>Anodonta anatina</i>) and hermaphroditic (<i>Anodonta cygnea</i>) ..., Emily Chase	Working together to mobilise biodiversity collections data in Canada, Anne Bruneau
08:30	A fitness trade-off between seasons causes multigenerational cycles in phenotype and population size, Gustavo Betini	Incorporating climate uncertainty into models of Spectacled Eider survival in Alaska, Katie Christie	Temporal variation shapes phenotypic and genetic diversity in bar-built estuary populations of threespine stickleback, Antoine Paccard	Incorporating novel ecosystems and layered landscapes for ecological restoration in cities, Valentin Schaefer	Thermal stress alters host-parasite interaction and drives parasite distribution in a marine invertebrate, Alyssa Gehman	Phylogeography of <i>Oreohelix</i> land snails in southern Alberta and Saskatchewan, Zach Dempsey	
08:45	The role of phenological assembly in plant communities, Elizabeth M. Wolkovich	Managing natural resources in the face of uncertainty in future environments, Byron K. Williams	Ecological interactions and genome structure contribute to repeatable patterns of genomic divergence in threespine stickleback, Diana J. Rennison	Socio-ecological interactions in the urban forests: Residents and their trees, Tenley Conway	The impact of non-pathogenic phylloplane bacteria on insect disease resistance: The importance of ecological context, Jenny Cory	What's in the box: Preliminary data from genomic signatures of adaptive diversification in box-ironbark eucalypts, Jasmine Janes	
09:00	Dynamics of seasonal adaptation in <i>Drosophila melanogaster</i> , Emily Behrman	Uncertainty in wildlife monitoring and management, Anne Loosen	Speciation seen through the lens of biomechanics: A multidisciplinary approach using fish locomotion and feeding in marine and freshwater threespine stickleback, Sean Rogers	Strategic planning for urban forestry in Canada: Sharing knowledge and engaging communities across disciplines, Adrina Bardekjian	Strong community structuring of defensive heritable symbionts is shaped by context-dependent transmission rates, Jacob Russell	Exploring the surprisingly finely dissected genomes of the <i>Helianthus</i> hybrid species, Gregory L. Owens	Discovering and archiving the tree of life, Wayne Maddison
09:15	Niche conservatism and evolution in fluctuating environments, Robert Holt	Climate and grazing management contribute to uncertainty about carbon storage and sequestration in the Canadian prairies, Cameron Carlyle	Genetic basis of covariation between temperature-associated traits in marine and freshwater threespine stickleback (<i>Gasterosteus aculeatus</i>), Sara J. Smith	Ecological health in Metro Vancouver: Current projects and emerging topics, Marcin Pachcinski	Microbial ecology of seaweed, Matthew Lemay	Comparison of genomic and microsatellite profiles from wolves and coyotes, Astrid V. Stronen	
09:30		The widespread failure of adaptive management in fisheries, Carl Walters	Lab versus wild: Phenotypic covariation in threespine stickleback, Tegan Barry	Whales, bees, forests, and birds: Raising the profile of biodiversity in Vancouver, Angela Danyluk	What's on your skin: New insights into the overall function and variation of skin microbiome in amphibians, David Lesbarreres	Characterizing fitness landscapes in Darwin's finches with a hierarchical model, Marc-Olivier Beausoleil	Climate change, phenology and species interactions: Opportunities and challenges of natural history collections, Heather Kharouba
09:45	Natural selection for life histories in seasonal environments, Mark Boyce		Effects of ecological context on the phenotypic divergence of stickleback ecotypes, Rebecca J. Best	Connecting urban ecology and municipal infrastructure, Michelle Molnar	Understanding the impacts of environmental exposure on gut microbiome diversity and host health using a wild population of deer mice..., Elliot Schmidt	Environmental marginality and range limits in <i>Arabidopsis lyrata</i> , Julie Lee-Yaw	
Coffee Break 10:00 - 10:30							

Mon							
	CSEE PhD diversity & excellence Research award symposium	Stickleback Salmonid ecology and evolution	NSERC scholarships & fellowships information	Exploring the roles of mechanistic and phenomenological models in ecology symposium	Stress, Antipredator behaviour	Phylogenetics Evolutionary theory	Museum collections symposium
Room:	Theatre	Saanich	Oak Bay 1	Oak Bay 2	Esquimalt	West Coast	Newcombe RBCM
10:30	Introduction	Diet specialization in Threespine stickleback (<i>Gasterosteus aculeatus</i>) in response to lake physical characteristics and the presence of Signal crayfish (<i>Pacifasticus leniusculus</i>), Douglas Curley	Natalie Weiskopf and Kathleen Lorenzo (NSERC scholarship & fellowship officers)	Mechanism and the unknown: Or, how to predict the future, Kim Cuddington	Systemic stress levels in Vancouver Island marmots may correlate to human intervention: Implications for the management of a critically endangered mammal, Madison J. Acker	Chromosome inversions and adaptation to heterogeneous environments in seaweed flies, Claire Merot	Elevation, crypsis, and community structure of neotropical arthropods, Sarah Dolson
10:45	Altered competition under ocean acidification influences species- but not community-level response to food supply, Norah Brown (UBC)	Eco-evolutionary interactions in stickleback elemental composition, Rana W. El-Sabaawi		Mechanism versus phenomenology in models of insect outbreak, Greg Dwyer	Maternal stress and predator odour effects on juvenile cuttlefish antipredator responses to ink and alarm cue, Kevin R. Bairos-Novak	The genomic significance of pervasive broad-scale heterogeneity in recombination rate along chromosomes during early population divergence, Marius Roesti	Reconciling phenological observations with flowering records in herbaria, T. Jonathan Davies
11:00		Morphological responses of threespine stickleback (<i>Gasterosteus aculeatus</i>) to two non-native predators, Hannah M. Kienzle		Mechanistic and phenomenological models for animal movement patterns in ecology, Mark Lewis	Effects of local predation pressure on prey fish behaviour and evasion of an invasive predator, Adrienne E. Berchtold	Tracing the footprints of a moving Setophaga warbler hybrid zone, Silu Wang	
11:15	Leaf bacterial diversity mediates plant diversity-ecosystem function relationships, Isabelle Laforest-Lapointe (University of Montreal)	Determinants of brook charr resource polymorphism in Canadian Shield lakes, Vincent Rainville		How do different modelling techniques compare to predict species and communities patterns?, Ben Bolker	Investigating the sub-lethal effects of predation in black tailed prairie dogs, Colleen Crill	The effect of ploidy level on the rate and spectrum of new mutations, Nathaniel Sharp	Using museum specimens and other best available data to assess insect conservation status: A lesson from the IUCN Red List bumblebees, Sheila Colla
11:30		Ecological drivers of covariance in productivity among Fraser River sockeye salmon conservation units, Cameron Freshwater		Prediction: What is it, why do we do it and how to do it better, Koryn Bodner	Exploring stress biomarkers in an avian model, Gillian Johnstone	The evolution of constraint as an adaptation, Andrew Simons	
11:45	Reptile phylogeny and the origin and early radiation of lepidosaurs, Tiago Simões (University of Alberta)	Patterns in salmon dynamics in space and time on the Central Coast of British Columbia, Eric Hertz		*Linking ecological theory and data* From ecological theory to empirical data, the missing statistical link, F. Guillaume Blanchet	Winter temperature experience affects cognitive responses in black-capped chickadees (<i>Poecile atricapillus</i>), Robert Jeff Martin	The genomics of purging inbreeding depression, Sarah J. Baldwin	The dead keep talking, Leah R. Ramsay
							Discussion
Lunch 12:00 - 13:30 (on your own)							

Mon							
	CSEE PhD diversity & excellence Research award symposium	Salmonid ecology and evolution	Conservation challenges associated with aquatic soundscapes symposium	Plant ecology	Policy and planning	Evolutionary theory Selection	Mate choice, hybridization
Room:	Theatre	Saanich	Oak Bay 1	Oak Bay 2	Esquimalt	West Coast	Newcombe RBCM
13:30	Multi-scale responses to warming in an experimental metacommunity, Tess Grainger (University of Toronto)	Glacial recession and salmon futures, Kara Pitman	Marine mammal vocalizations in a changing Arctic soundscape: Impacts of decreased sea ice and increased ship traffic, William Halliday	The inclusion of positive interactions in modeling the niche space of desert annuals, Alessandro Filazzola	Assessing biodiversity response to land-use and climate change in Nova Scotia: A proposed ecosystem framework, Sean Basquill	Evolutionary bargaining games: Ecological and evolutionary stability in a consumer-resource based model of mutualistic interactions, Gordon G. McNickle	
13:45		Canada's wild salmon policy: An assessment of conservation progress, Michael H. Price	The effects of anthropogenic and biological noise on fish behavior and physiology: A meta-analysis, Francis Juanes	Population level variation in host plant response to multiple symbionts, James Franklin	Addressing the potential cumulative impacts of land use and climate change on fish and wildlife in northern Ontario, Cheryl Chetkiewicz	The genetic signature of evolutionary rescue with sex, Matthew Osmond	Do mate choice errors slow the spread of the invasive brown spruce longhorn beetle?, Jennifer Anderson
14:00	Looking through the bottleneck: Genomic analysis of historical and contemporary population genetic variation in the Pinzon Island Galapagos tortoise, Evelyn Jensen (UBC-O)	Long-term shifts in the phenology of juvenile salmon migration across species and location, Jonathan Moore	Motorboat noise disrupts co-operative interspecific interactions, Isabelle Côté	Fungal bio-fertilizers can affect local plant communities, Vasileios Kokkoris	Freshwater conservation planning in an intact landscape, Brie Edwards	Life history trade-offs, sexual conflict, and the maintenance of variation in <i>Drosophila melanogaster</i> , Devin Arbutnott	Female preference for alternative male morphs in the Kribensis cichlid (<i>Pelvicachromis pulcher</i>), Peter Hurd
14:15		Experimental and natural nutrient subsidies alter steelhead life history, Colin J. Bailey	Tracking marine mammals in the presence of human induced ocean noise, Ben Hendricks	Mast seeding patterns in five North American conifer genera (1912-2014), Jalene LaMontagne	Phylogenetic patterns of amphibian community disassembly from concurrent land-use change and climate, Dan Greenberg	Variation in symbiont preference drives symbiont evolution, Rebecca T. Batstone	Flexible mate choice may regulate gene flow between sympatric pumpkinseed sunfish ecotypes (<i>Lepomis gibbosus</i>), Beren Robinson
14:30	Congratulations	Genome wide association and signatures of selection studies for sea age in North American Atlantic salmon populations using Next Generation Resequencing and the new North American 50K SNP chip, Elizabeth G. Boulding	Understanding a dolphin's soundscape to assess the potential changes in habitat use, Matt Pine	Can traits predict changes in species abundance?, Julie Messier	Proactive conservation planning for high-value habitats of caribou and grizzly bears in the Muskwa-Kechika Management Area, northeast British Columbia, Nobuya Suzuki	Phenotypic selection on architectural effects in <i>Delphinium glaucum</i> (Ranunculaceae), Ilona Clocher	Rapid evolution of reproductive isolation during speciation: Evidence from <i>Lochmaea capreae</i> leaf beetle, Shaghayegh Soudi
14:45	*Application in ecology and evolution* Ecology vs. evolution: Comparing applications of research fields, Jeff Bowman	Reduced growth in wild juvenile sockeye salmon infected with sea lice, Sean Godwin	Ambient noise from natural sources and shipping in the western Canadian Arctic, Stephen Insley	Drivers of variation in the sugar maple (<i>Acer saccharum</i>) leaf and root microbiome along environmental gradients, Steven Kembel		Survival by genotype: Patterns at Mc1r are not black and white at the White Sands ecotone, Simone Des Roches	Sexual conflict can constrain the evolution of reinforcement, Alison Wardlaw
Coffee Break 15:00 - 15:30							

Mon	Social systems	Salmonid ecology and evolution	Ecology of Plant-Herbivore Interactions in Cold Places	Plastics in the environment	Policy and planning	Evolution Communication	Reproductive ecology and behaviour
Room:	Theatre	Saanich	Oak Bay 1	Oak Bay 2	Esquimalt	West Coast	Newcombe RBCM
15:30	Exploring the evolution of eusociality in a primitively eusocial paper wasp using population genomics, Kathleen Dogantzis	Fishing for sympatry: Historical and contemporary neutral processes shaping Arctic char (<i>Salvelinus alpinus</i>) in Labrador, Canada, Sarah Salisbury	*Conservation* Marine vessel movements: Mitigation of noise through data collection, strategic planning, and management support, Rosaline Canessa	Plastic pollution in the total environment: A review of marine plastic contamination in Newfoundland and Labrador, Canada, Justine Ammendolia	Taking the path of least resistance: how conservation science got left behind in the design of the largest Canadian marine protected area, Rodolphe Devillers	Multilevel and sex-specific selection on competitive traits in North American red squirrels, David Fisher	Identifying correlates of captive breeding success in amphibians, Alannah Biega
15:45	Competitive interactions and the mechanisms behind negative frequency-dependent selection on aggression, Julia Kilgour	Dietary thiaminase and its effects on reproductive traits in three populations of Atlantic salmon, Kimberly T. Mitchell	The chemical arms race between hungry herbivores and clever plants, Jennifer Forbey	Microplastic ingestion by <i>Venerupis philippinarum</i> and <i>Crassostrea gigas</i> on intertidal shellfish farms and 'wild' beaches in BC, Canada, Garth A. Covernton	Timing of protection of critical habitat matters, Tara G. Martin	Is the experimental evolution of wild red squirrels repeatable?, Andrew G. McAdam	Parent-offspring cannibalism in the plainfin midshipman fish, Aneesh P. H. Bose
16:00	The effect of individual variation of sociality on reproductive success and body condition in a Canadian population of black-tailed prairie dogs, Jillian M. Kusch	Environmental pathogen transmission between farmed and wild salmon populations, Dylan Shea	Grazing Arctic tundra: Plant to ecosystem responses, Greg Henry	Determining the efficacy of depurating microplastics from Pacific oysters (<i>Crassostrea gigas</i>) , Maggie M. Dietterle	Redefining ecological integrity by decoupling energy capture and conversion, Charles Martin	Assignment methods tailored for RADseq data in conservation genomics, Thierry Gosselin	Repeatability and reproductive consequences of boldness in female grey seals, David Coltman
16:15	Nest-site competition and the socioecology of reproduction in eastern carpenter bees, Miriam Richards	A test of parallelism in the axes of morphological divergence in Icelandic arctic char (<i>Salvelinus alpinus</i>), Matthew Brachmann	Effects of resource manipulation on temperate grassland vegetation under a changing climate, John Serafini	Influence of subtidal and intertidal shellfish farming on microplastic contamination in cultured Pacific oysters (<i>Crassostrea gigas</i>) from British Columbia, Matthew R. Miller	The effect of target setting on conservation in Canada's boreal: What is the right amount of area to protect?, Darren J.H. Sleep	The quantifiable value of outreach to herpetofaunal conservation, Sean P. Boyle	More reasons why picking the right spatial scale is so #@&! hard, Andrew D. Moraga
16:30	Effects of neighbour familiarity on intrusion risk and behavioural time budgets in a territorial squirrel (<i>Tamiasciurus hudsonicus</i>), Erin Siracusa	Population genetics of Athabasca River Basin bull trout (<i>Salvelinus confluentus</i>), Emma K. Carroll	Climate and land use inform range expansion of a large boreal herbivore in a novel agro-ecosystem, Michel P. Laforge	Evaluating contaminants associated with plastic ingestion in an Arctic seabird, Jennifer Provencher	Global Human Footprint project, Oscar Venter	What does the tweet say: The use of social media for science communication, Alina Fisher	Spatial autocorrelation of white-throated sparrow song variation at the neighbourhood scale, Scott M. Ramsay
16:45	How did egg-laying and work behaviours decouple from solitary antecedents to eusocial castes?, David N. Awde	Intraspecific resource competition and phenotypic selection in polymorphic Arctic char (<i>Salvelinus alpinus</i>), Oliver Franklin	The role of bison as ecosystem engineers in the aspen parkland, Peter Tarleton	Plastics and other anthropogenic debris in freshwater birds from Canada, Dave Shutler	Prioritizing management actions when data is scarce and systems are complex, Laura Kehoe	Media and storytelling as a tool for science communication, Josh Silberg	The causes and consequences of the variability in incubation behaviour in tree swallows (<i>Tachycineta bicolor</i>), Nghia Tran
			Reconstructing habitat change at a multi-species goose breeding area, East Bay, Southampton Island, Nunavut, Peter Kotanen				
	Theatre	Saanich	Oak Bay 1	Oak Bay 2			
18:00 – 20:30	Anne Salomon, Public Lecture Adapting to Surprise in Our Coastal Oceans: Lessons from Kelp Forests, Ancient Clam Gardens and Pacific Herring						

Poster Session A: Monday 16:00 - 18:15

Tue										
Room:	Theatre	Saanich	Oak Bay 1	Oak Bay 2	Esquimalt	West Coast	Newcombe RBCM	level 2: Sidney	level 2: Colwood	level 2: View Royal
	Remote camera networks to scale up ecological insights and conservation applications symposium	The tension between science and advocacy in ecology, evolution, and conservation biology symposium	Ecological epigenetics symposium Bird Migration	Metacommunity theory for real-world communities: theoretical and empirical advances for trophic metacommunities symposium	Population dynamics	Life histories: phenology, sex, sex ratio	Complex coevolution: understanding how coevolution may operate differently across diverse interaction types, systems, and scales symposium	Consequences of Rapid Ecological Change in Mountain Ecosystems Symposium	Ecology & Evolution in Biodiversity a Social Context Symposium	
08:00	Promise and pitfalls of scaling up ecological insights using remote cameras, Cole Burton	Safeguarding scientific credibility in ecology and conservation biology, Mark Vellend	Why so bitter? The epigenetics of flavour and aroma in hops., Linda Rutledge	Current advances and future challenges of reconciling the horizontal metacommunity with a vertical world, Coreen Forbes	Eco-evolutionary dynamics in a contemporary human population, Patrick Bergeron	Differences in early life history traits between sexual and asexual Easter daisies favor the establishment of asexuals , Evan Hersh	Pollen specialization by bees and pollen protection by plants: is there an arms race?, Jessica Forrest	A century of ecosystem change in the Canadian Rocky Mountains, Andrew Trant	Selection on colony foraging aggressiveness favors social susceptibility in social spiders, Jonathan Pruitt	A multi-method comparison of substratum community assessment techniques and the implications for diversity indices a..., Kieran D. Cox
08:15	Landscape and climate change: Ecological insights from camera-trap research, Jason T Fisher	Getting out of the ivory tower: Informing policies for reforestation, conservation and climate change, Sally Aitken	Genetic and epigenetic response to the Deepwater Horizon oil spill in <i>S. alterniflora</i> , Marta Robinson	A general framework for trophic metacommunity ecology, Laura Melissa Guzman	Are populations of migratory tree-roosting bats declining?, Erin Baerwald	Diet-dependent sex ratios in <i>Tigriopus californicus</i> : Evidence for ESD in a system with stable PSD, Erin Hornell	Evolution and specificity in an insect defensive symbiosis, Steve Perlman	The conservation value of mountain environments to birds in North America, Kathy Martin	Social structure modulates the evolutionary consequences of social plasticity: A social network pers..., Pierre-Olivier Montiglio	Functional diversity in fragments: The joint effects of ecological drift and deterministic responses, Leila Forsyth
08:30	Trophic traps: Inferring species relationships from camera trap imagery, Adam Ford		Mercury rising: Epigenetic response to mercury exposure in songbirds, Kristin Brzeski	Simple rules for complex spatial food web dynamics, Dominique Gravel	Meta-analyses reveal the world is truly chaotic: How did humans succeed in such a place?, Nicholas C. Collins	The effects of climate change on sex determination and growing time in a northern population of snapping turtles, Melanie Massey	Sanctions, partner recognition, and variation in mutualism, Jeremy Yoder	Spatial genetic structure of Alberta's bighorn sheep: Population resilience and implications for harvest management, Jamie Gorrell	Social relationships shape vocal interactions of male Black-capped Chickadees at dawn, Dr. Jenn Foote	Measuring diversity using entropy (Shannon), covariance (Simpson), and independence (linkage disequilibrium), Root Gorelick
08:45	A new Automated Behavioural Response system to integrate playback experiments into camera trap studies, Liana Zanette	Scientific integrity and contributions to policy: Seeing the limits, Jeremy Kerr	Ants and plants: Epigenetic responses to multiple mutualist partners, Rebecca Kartzinel	Embracing variability: Food webs in space and time, Kevin McCann	Climate change effects on the predator-prey relationship between polar bears and common eider seabirds, Cody Dey	Decomposing direct and indirect effects of early-life environment on fitness of bighorn ewes, Gabriel Pigeon	Coevolution's ups and downs: A long-term study of sex in a natural population, Amanda Gibson	Are coastal mountains responding to climate change differently?, Luise Hermanutz	Ecological variation, mate sharing, and the potential for sperm competition in Wellington tree weta, Dr. Tina Wey	Using environmental DNA to monitor winter aquatic biodiversity, Jori B. Harrison
09:00	A comparison of multiple spatial capture-recapture models for estimating carnivore densities using field data, Joanna Burgar		Epigenetic changes in natural populations: Its role in the demography of cyclic mammals, Rudy Boonstra	Cascading effects of spatial structure across trophic levels, Rachel Germain	The strength of density-dependence in mountain ungulates varies over time, Marco Festa-Bianchet	The role of coding trinucleotide repeats within candidate genes in the adaptation of an iconic northern mammal, Canada lynx (<i>Lynx canadensis</i>), Melanie Prentice	Co-evolution across the spectrum of host/microbiota integration, Laura Parfrey	Where fast is slow: Experimental effects of changing soil temperature and nutrients on a subarctic, alpine plant community, Jill Johnstone	Root behavioral responses to nutrients and neighbors, Dr. J.C. Cahill	Diversity productivity relationships across scale, Eric G. Lamb
09:15	Camera trap surveys to inform management decision making, Angela Fuller	The distinction between advice and advocacy in science, Jeff Hutchings	Sex differences in migratory restlessness of black-throated blue warblers during spring migration, Jessica Deakin	Ecological drift across trophic levels: Consequences for metacommunities, Denon Start	Why most studied populations should decline, Stephen Heard	Shifting birthdates in bighorn sheep: Can individuals track changes in local weather?, Limolou-Amélie Renaud	The role of coevolution in the assembly and disassembly of mutualistic communities, Scott Nuismer	Whitebark pine on the edge? Abiotic and biotic drivers interact to limit species range, Alana Clason	Gene-environment interplay in behavior and evolution: lessons from <i>Drosophila melanogaster</i> , Dr. Julia Saltz	Preserving phylogenetic diversity can be a poor strategy for preserving functional diversity, Florent Mazel
09:30	Advancing field conservation by developing new camera trap methods and collaborations in the Pacific Northwest, Robert Long		Stopover timing and refueling in relation to migration distance and sex in Wilson's warbler, Yolanda E. Morbey	Coupled spatial-trophic dynamics in bromeliad food webs, Diane Srivastava	What causes cyclical population dynamics? The roles of disease and fecundity in the western tent caterpillar, Paul MacDonald	Lack of diapause in aphid parasitoids from mild winter areas: Ecological and evolutionary insights, Kévin Tougeron	Cooperation, conflict, and coevolution, Megan Frederickson	Canada's mountain ecosystems: Towards a better integration of biotic and abiotic drivers of rapid change, David Hik		Are the most evolutionary distinct species the most original?, Vahab Pourfaraj
09:45	Monitoring large-scale trends in wildlife populations using remote cameras, Jesse Whittington	Conservation of peripheral populations illustrate the tension between advice and advocacy in the absence of scientific consensus, Jeannette Whitton	Large variation in migration routes of hybrid flycatchers, Thor Veen	*Grassland trophic cascades* Songbirds and small mammals cause trophic cascades in montane grassland ecosystems, William Harrower	Population dynamics of the adopted migrant life history in fish, Luke A. Rogers		*Bacterial Symbiosis* Diversity and nutritional mutualism of Wolbachia in Bat flies (<i>Streblidae</i> , <i>Nycteribiidae</i>), Haewon Shin	Drivers of post-fire understory regeneration in the conifer dominated boreal forest of southern Northwest Territories, Alison White	Discussion	Diversity-stability hypothesis: Are we looking at the right scale?, Guillaume Rheault
Coffee Break 10:00 - 10:30										

Tue	Remote camera networks Mammalian movement and activity	Pollution	Pollination systems	Seagrass ecology and conservation along Pacific and Atlantic coasts symposium	Life histories: reproduction, senescence	Animal diet	Life On the Edge: Mechanisms of Adapting to Climate Change Symposium	Foraging	Genetic structure of populations	Biodiversity
Room:	Theatre	Saanich	Oak Bay 1	Oak Bay 2	Esquimalt	West Coast	Newcombe RBCM	level 2: Sidney	level 2: Colwood	level 2: View Royal
10:30	Flying cameras: Promises and pitfalls of drones for wildlife ecology, Sophie Gilbert	Wildlife health indicators and mercury exposure: A case study of river otters (<i>Lontra canadensis</i>) in central British Columbia, Canada, Shannon M. Crowley	Understanding multiyear variability in the yield of pollinator dependent highbush blueberry (<i>Vaccinium corymbosum</i>), Kyle Bobiwash	Secondary production of macrobenthic communities in seagrass (<i>Zostera marina</i> , eelgrass) beds and bare soft-sediments across differing environmental conditions in Atlantic Canada, Melisa Wong	Post-reproductive lifespan and grandmothering in a pre-industrial human population, Sacha C. Engelhardt	Untangling aquatic food webs using DNA and text-mining, Zacchaeus G. Compson	Evolutionary traps: A role for niche conservatism in limiting species' responses to global change, Jeremy Kerr	Habitat-mediated predation and selective consumption of spawning salmon by bears, Luke Andersson	A resistance mapping approach to assess landscape effects on genetics and dispersal of the Rocky Mountain Apollo butterfly, Helen Chen	Decoupling habitat fragmentation from habitat loss: Butterfly assemblages on lake islands support the habitat amount hypothesis, Zachary G. MacDonald
10:45	Fish on film in the temperate deep: An underwater method comparison, Lily Burke	Oil sands and the marine environment: Current knowledge and future challenges, Stephanie J. Green	Pollinator-mediated facilitation explains asymmetric rarity advantages in experimental plant communities, Katie Brown	Seascape connectivity effects on the nursery value of temperate seagrass ecosystems, Angeleen Olson	Variation in the timing and magnitude of peak reproductive effort affects rate of senescence, Anni Hämäläinen	A century of ecological change reflected in the stable isotopes of a migratory aerial insectivore, Philina English	Demographic compensation and climatic tipping points in monkeyflowers, Amy Angert	Does access to anthropogenic food subsidies affect glucose metabolism of raccoons?, Albrecht Schulte-Hostedde	Population genomics of white-tailed deer (<i>Odocoileus virginianus</i>) introduced on Anticosti Island, Jérémie Fuller	Competing taxa suppress each other's diversity, Abdel Halloway
11:00	Camera trapping for pollinators: Using time-lapse cameras on a flower lure to index pollinators in fragmented boreal forests, Federico Riva	Parasitic infection: A missing piece of the ocean acidification puzzle, Colin D. MacLeod	Pollinator-mediated impacts of alien plants on natives: New data provide new insights, Julia Charlebois	Evaluating the seasonal use of estuarine habitats by juvenile salmon and resident fish communities, Lia Chalifour	Morphological changes in offspring associated with parental senescence, Robert Laird	DNA metabarcoding reveals the broad and flexible diet of a declining aerial insectivore, Beverly McClenaghan	Tundra plant responses to experimental warming and snowmelt timing, Esther Frei	Behaviour of animals in wild populations within urban vs suburban habitats, Jesse Hacker	The effect of landscape on genetic differentiation in western Alberta populations of the alpine butterfly <i>Parnassius smintheus</i> , Melissa Lucas	Effects of disturbance and environmental factors on plant communities at freshwater springs, Kayleigh G. Nielson
11:15	Carnivore activity patterns in relation to landscape development and competitor co-occurrence, Sandra Frey	Impacts of industrial noise on owl occupancy and seasonal use in the boreal forest, Julia Shonfield	Clonal growth increases outcross mating opportunities, Marcel E. Dorken	Seagrass genetic diversity enhances production at multiple life history stages, Randall Hughes	Effects of urbanization on fish life history traits: Lessons from guppies, Piata Marques	Stable isotopes and fatty acids reveal freshwater aquatic prey in the diet of wolves, Sean A. O'Donovan	Coral symbiosis and survival during the 2015/2016 El Niño event, Danielle Claar	Applying the functional response framework to human-pest interactions, Mélodie Kunegel-Lion	Population genetics and invasion history of the invasive European fire ant, <i>Myrmica rubra</i> , in Toronto, Ontario, Canada, Shannon A. Meadley Dunphy	Using plant traits to understand plant-soil feedback in temperate forests, Jonathan A. Bennett
11:30	Camera traps tell us where animals live, but more so, where animals move, Frances Stewart	Inferring growth dilution from latitudinal variation in fish growth and mercury bioaccumulation, Shyam Thomas	Pollinator-dependent invasive species impacts on network structure and community traits, Sandra Gillespie	Turning up the heat on seagrass wasting disease, Morgan Eisenlord	Does habitat selection constrain adaptive life-histories?, Douglas W. Morris	A temporal shift in prey species availability decreases trophic diversity in community structure among a predator assemblage in a changing Arctic, David J. Yurkowski	Preserving adaptive capacity under intensifying ocean acidification, Terrie Klinger	Predator functional responses: Breathing new life into old theory, Dennis Murray	Ancient diversification in glacial refugia leads to intraspecific diversity in caribou, Jean L. Polfus	Local plant diversity responses to temperature and water availability: Synthesizing evidence from experimental data, Véronique Boucher Lalonde
11:45	Spatially explicit density estimation in a large-scale grizzly bear study using spatial capture-recapture models, Andy J. Royle	Calcified herbivore loss may disproportionately drive responses to ocean acidification in natural communities. Kathryn M. Anderson	Global trends in pollinator community diversity and composition in response to interactive climate and land-use changes, Peter Soroye	Effects of multiple disturbances/stresses on eelgrass epifaunal communities, Mathieu Cusson	Hunting promotes slow life histories in brown bears, Joanie Van de Walle	Vertebrate-wide scaling of metabolic rate and respiratory surface area, Jennifer S. Bigman	Transcriptomic variability in population responses of Atlantic cod to temperature, Rebekah Oomen	Has predator management neglected to consider the impact of ecology on predator behaviour?, Kyle Plotsky	Genomic insights into local adaptations in <i>Ovibos moschatus</i> , Erin Prewer	Patterns of plant succession and scale of observation in an extreme environment, Katriina O'Kane
									Tremendous genetic drift and accumulation of deleterious mutations may not preclude thermal adaptation in lake trout, Anne-Laure Ferchaud	Assessing birds and lichen as indicators of biodiversity in a managed subboreal watershed in British Columbia, Kerrith McKay
Lunch 12:00 - 13:30 (on your own)										

<p>Tue Living in the eco-evolutionary theatre: research guided and inspired by intensive field observations symposium</p> <p>Canadian protected areas in a changing climate: A cross-ecosystem approach symposium</p> <p>Species interactions in a warming world symposium</p> <p>Marine ecology</p> <p>Ecological, evolutionary and environmental synthesis in the 21st century symposium</p> <p>Community ecology</p> <p>Forest ecology</p> <p>Parasitism and symbiosis</p> <p>Genetic structure of populations</p> <p>Aquatic ecology</p>										
Room:	Theatre	Saanich	Oak Bay 1	Oak Bay 2	Esquimalt	West Coast	Newcombe RBCM	level 2: Sidney	level 2: Colwood	level 2: View Royal
13:30	Variation of lateral plate phenotypes in threespine stickleback fish: Adaptation, developmental constraint, or both, Mike Bell	Integrating static and dynamic spatial management for biodiversity persistence under climate change, Shawn Leroux	Shifts in insect development rate alter phenological overlap and community interactions, Lauren Buckley	Biotic homogenization of seagrass fishes associated with coastal anthropogenic activities, Josephine Iacarella	Ecological, evolutionary and environmental synthesis in the 21st Century , Stephanie Hampton	Population responses of rodent species to agriculture on the Great Plains of Canada, Leanne Heisler	The role of disturbance on treeline establishment and range expansion from a seed's perspective, Lucas Brehaut	Describing the cophylogenetic relationship between the <i>Myrsidea</i> chewing louse and its Neotropical <i>Mionectes</i> flycatcher host, Andrew Cook	Fine-scale genome-wide analysis of spawning herring (<i>Clupea harengus</i>) populations in the Northwest Atlantic, Angela P. Fuentes-Pardo	Weak correlation between assemblages of non-biting midges (Diptera: Chironomidae) and environmental factors in wetlands in Alberta, Canada , Heather Proctor
13:45		Protected areas: How to design resilient networks using connectivity, Christopher Blackford	Dispersal governs the reorganization of ecological networks under environmental change, Patrick Thompson	Identifying human impacts on eelgrass faunal biodiversity in Barkley Sound, Vancouver Island, Emily Adamczyk		Forest fragmentation differentially affects the movement behavior of the main pollinator and seed disperser of a tropical understory herb, Luis A. Arias-Medellin	From rares to richness: Spectrums of plant rarity and diversity in the boreal forest, Varina Crisfield	Alternative management of <i>Varroa</i> destructor mites using their odour responses, Allie Flinn	Geographic variation in the genetic structure of a mussel hybrid zone, David J. Innes	How Pacific salmon shape streams and riparian forests: Implications for ecosystem-based management, Jessica C. Walsh
14:00	The evolution of interspecific interactions, Dolph Schluter	Responses of marine habitat-forming organisms to climate change: conserving the stage when the players build the set, Jennifer Sunday	Temperature dependency of consumptive dynamics and dispersal structure local and regional coexistence, Benjamin Gilbert	Benefits and challenges of UAV mapping for seagrass ecology and conservation, Natasha Nahimick	Maladaptation, Steven Brady	Testing for variation in competition importance and intensity among old-field plant species, Brandon Schamp	Intact forest landscapes: Definitions, use, and clarity. Kate Edwards	Host allometry influences the evolution of parasite host-generalism, Amy L. Hurford	Landscape community genomics in the mountain pine beetle outbreak system, Patrick James	Diversity meets decomposition: Are local decomposer communities influenced by local riparian conditions?, Natalie Westwood
14:15	A gillnet fishery considered as an experiment in artificial selection, Graham Bell	Integrating climate risk and refuge into data-driven portfolios of protected areas, Emily Darling	Identifying gaps and priorities in understanding climate change impacts on food webs, Erin Cameron	Preferred prey hotspots for juvenile salmon in the Skeena estuary, Michael Arbeider	Cross-scale resilience from theory to practice: Results from a synthesis collaboration, Shana Sundstrom	Relative importance of colonist quantity, quality, and arrival frequency to the extinction of two zooplankton species, James S. Sinclair	Vegetation dynamics in SpaDES: The recoded LANDIS-II biomass succession model, Yong Luo	Fine-scale spatial correlations of parasite prevalence with final-host abundance and waterbody age in a waterfowl- <i>Gammarus</i> -acanthocephalan system, Zhuoyan Song	Genetic structure of rhinoceros auklet populations throughout the North Pacific, Marie Prill	National and regional scale patterns of benthic insect beta-diversity in Canadian rivers, Colin J. Curry
14:30	Adaptive Polymorphism in Flatfishes, Carolyn Bergstrom	Planning for Neo-tropical migratory bird conservation under climate change, Ilona Naujokaitis-Lewis	Dynamics at the warm edge: Species interactions vs. species distributions, Anna Hargreaves	Migratory salmon usage of estuary nursery habitat, Ciara E. Sharpe	Evolutionary rescue comes of age: An account of the growth in our understanding through theory and experiments, Andrew Gonzalez	What is the nature of the interaction between a flower weevil and a leaf beetle, two biocontrol agents of purple loosestrife: Competitive, complementary, or neutral?, Marina Torreblanca	Host mycorrhizal association and soil fertility Influence plant-soil feedback in a Diptero carp rainforest, Max Segnitz	Adaptive genetic variation at salivary protein genes in blood-feeding generalist ectoparasites, Benoit Talbot	Fine-scale genetic structure and effective size of an isolated and endangered population of woodland caribou, Geneviève Turgeon	Factors affecting decomposers and decomposition dynamics differ in boreal peatlands, Carlos Barreto
14:45		Discussion	Biotic and abiotic constraints on treelines globally, Carissa Brown	Effects of shellfish farming on invertebrate and finfish communities, Sarah Dudas	Integrating community assembly into biodiversity-ecosystem function relationships: The CAFE approach, Katherine H. Bannar-Martin	Harnessing ecological networks to understand anticancer immunity in the tumor microenvironment, Phineas Hamilton	Evaluating differences in plant community composition and stand structure caused by road fragmentation in forested wetlands, Caitlin Willier	Inherited <i>Spiroplasma</i> symbionts are common in the ant genus <i>Myrmica</i> , Matthew J. Ballinger	Assessing genetic structure in subalpine larch (<i>Larix lyallii</i>), a high-elevation deciduous conifer species, Marie C. Vance	Drought causes shift in functional role of aquatic macroinvertebrate from shredder to predator, Sarah Amundrud
Coffee Break 15:00 - 15:30										

Tue Living in the eco-evolutionary theatre: research guided and inspired by intensive field observations symposium

Anthropogenic influences on habitat selection

Species interactions in a warming world symposium | Effects of climate change

Coral reef ecology

Ecological, evolutionary and environmental synthesis in the 21st century symposium

Landscapes

Forest ecology | Fish ecology

Marine ecology

Genetic structure of populations

Invasive species

Room:	Theatre	Saanich	Oak Bay 1	Oak Bay 2	Esquimalt	West Coast	Newcombe RBCM	level 2: Sidney	level 2: Colwood	level 2: View Royal
15:30	Spawning Pacific herring: ecological consequences and insights into the past , Caroline Fox	Anthropogenic disturbance affects energetic trade-offs with predation risk in white-tailed deer (<i>Odocoileus virginianus</i>), Siobhan Darlington	*Species interactions in a warming world* Functional trait distance predicts carbon flux shifts across a globally replicated removal experiment in mountains, Chelsea Chisholm	A methodology for evaluating the resilience of ecosystem services: A coral reef case study, Bruno Carturan	Dynamics of collapse and recovery in a marine community: insights from multivariate dynamic statistical approaches, Eric Pedersen	Building a continuous adaptive management system in SpaDES: Using historical landscape variation for the LandWeb project, Eliot McIntire	Should I stay or should I go? Range stasis versus range shifts of plants in the North Cascades, Rachel Wilson	The value of ancient habitat modifications: Macrofaunal communities of First Nations' clam gardens, Morgan Black	Immune gene functional heterozygosity affects survival in caribou, Marianne Gagnon	How do mountain pine beetle attacks impact understory vegetation in lodgepole pine forests in a novel area in west-central Alberta?, Julie Steinke
15:45		Human activity at oil and gas well sites influences avoidance response and habitat use by caribou, Doug MacNearney	The impacts of climate change on fungal communities in boreal peatlands, Asma Asemaninejad	Fish movement drives spatial and temporal patterns of nitrogen availability on coral reefs, Fiona T. Francis	Making ecosystem science matter: Stakeholder-engaged research through co-design and integ..., Roxane Maranger	Rapid evolution accelerates the expansion of plant populations in fragmented experimental landscapes., Jennifer Williams	Determining abundance of forage lichens for boreal woodland caribou in a fire-prone region of the Boreal Shield Ecozone, Ruth J. Greuel	Global marine protected areas to prevent extinctions, Lindsay N. K. Davidson	Genomic patterns of parallel ecological speciation in <i>Littorina saxatilis</i> ecotype pairs, Tony Kess	New house, new rules: Life-history strategies can enhance invasion success of introduced species, Danielle Denley
16:00	Emergent properties from a fledgling project with long-term vision: Bear-salmon-human systems in coastal British Columbia, Chris Darimont	Habitat heterogeneity and functional responses explain seasonal and behaviour-based selection of regenerating seismic lines for a social predator, Karine Pigeon	Spatial and temporal patterns of bobcat and lynx distributions in British Columbia, T.J. Gooliaff	Quantifying changes in the 3D structural complexity of coral reefs around Kiritimati following El Niño-induced mass coral bleaching, Jennifer M. T. Magel	Integrating stress ecology to illuminate biodiversity-ecosystem function research, Donald Baird		Are plants able to utilize nitrogen released from thawing permafrost? Implications for feedbacks with the climate system, Lucas J. Albano	If you cease it, will they come back? How exposure to and release from a pollution disturbance shapes rocky intertidal communities in British Columbia, Aaron M. Eger	Sharp reduction in genetic diversity of the coastal tailed frog (<i>Ascaphus truei</i>): A phylogeographic study using multiple methods, Cherie Mosher	Comparative genomics of historic marine invaders: Neutral and selective processes influencing the success of the amphipod <i>Corophium volutator</i> and polychaete <i>Hediste...</i> , Anthony Einfeldt
16:15	Are camouflaged flounder hiding from predators or prey?, John Taylor	Large mammal responses to seismic line restoration, Erin Tattersall	Fasting season length determines temporal limits for global polar bear persistence, Péter Molnár	The unseen world of coral reefs: Impacts of local and global stressors on the coral microbiome, Jamie McDevitt-Irwin	The ultimate challenge: Synthesizing theory and data to understand ecological change, Mary O'Connor		A novel approach to estimating fish densities using underwater cameras, Rowshyra Castañeda	Variation in intimacy between sea stars and their associated bacteria, Andrew Loudon	Genetic rescue of a wild population of bighorn sheep, Marc-Antoine Poirier	Using geographically weighted logistic regression to evaluate invasive species presence in the Adirondack Park Region, USA, Jelena Grbic
16:30	Stability and change in the evolutionary dynamics of color-pattern loci, Patrik Nosil	Patch occupancy of two boreal mammals in response to salvage logging, Julie Thomas	Loss of early-winter snow threatens alpine butterfly populations, Jens Roland	Redundancy in system-indicators reveals exploitation impacts in coral reef fisheries, James Robinson			Lowering the detection threshold: eDNA detection of low density juvenile salmon in a controlled experiment, Jeffrey C. MacAdams	Taxonomic turnover across salinity gradients, Melissa Chen	Analyses of American mink (<i>Neovison vison</i>) haplotypes in Ontario and Nova Scotia, Krista Shofstall	Non-native freshwater macroinvertebrates have density- and resource-dependent effects on ecosystem functioning, Chelsea J. Little
16:45	The architecture of adaptation: A master mutation or a mass of mutations?, Catherine Peichel	Understanding predation and energy limitations on woodland caribou recruitment through habitat selection, Rebecca Viejou	Effects of gene flow on performance at the northern range margin of <i>Clarkia pulchella</i> , Megan Gene Bontrager				Sockeye it to me! Landscape controls on population carrying capacity in data limited populations, William I. Atlas	Emergent consumption and ecosystem impacts of invasive Chinook salmon in Patagonia, Nicolas Munoz	Exploring the genetic basis of autoimmune disease through the differential expression of foxp3 in zebrafish (<i>Danio rerio</i>) follow..., Russell Easy	The diversity-invasibility relationship: Does spatial scale really explain the invasion paradox?, Nicola S. Smith

Poster Session B: Tuesday 16:00 - 18:15

17:15 A decade of spatial variation in Darwin's finches, Andrew Hendry

17:30 Fishing for the secrets of evolutionary change in vertebrates, David Kingsley

18:00 - 20:00 Oak Bay:
CTSWS Annual General Meeting

19:00 - 22:00 Garricks Head pub
Strategies for success: Student and postdoc workshop series

18:00

Wed								
	Using experimental evolution to reveal the eco-evolutionary impacts of global change symposium	NSERC Updates	Sensory and Behavioural Ecology symposium	Movement, activity, wildlife management	Habitat selection and use	Forest ecology	Linking Environmental Law and Science Symposium	
Room:	Theatre	Saanich	Oak Bay 1	Oak Bay 2	Esquimalt	West Coast	Newcombe RBCM	
08:00	Evolutionary rescue comes of age: An account of the growth in our understanding through theory and experiments, Andrew Gonzalez	NSERC Update John Reynolds, Opening the Black Box of NSERC's Discovery Grant Evaluations	Marine visual ecology: Insights from flatfish and decapod shrimp, Tom Iwanicki	Evaluating a movement-based method for inferring calving and calf survival, Maegwin Bonar	Evaluating habitat specialization of North American birds using a spatial null model, Carmen Chelick	Responses of boreal forests to warming-induced permafrost thaw, Jennifer Baltzer	Watershed connections in environmental decision-making, Jonathan Moore	
08:15	Fisheries-induced evolution: Insights from experimental populations of guppies, Beatriz Diaz Pauli		Visual ecology of the starry flounder, Ilaria Savelli	Natural regeneration on seismic lines influences movement behaviour of wolves and grizzly bears, Laura Finnegan	First assessment of hybrid poplar plantations as a suitable habitat for small mammal species in Quebec, Justine Fontaine-Topaloff	Influence of moisture and nutrient availability on <i>Alnus viridis</i> function across topographic gradients on the low arctic tundra, NWT, Katherine Black	Burden of proof, standard of proof: Revealing the chasm between science and law, Lynda Collins	
08:30	An experimental test of the effects of rapid evolution on species coexistence in the field, Martin Turcotte		Reconstructing ancient whale rhodopsin: Dim-light vision over a major evolutionary transition, Sarah Dungan	Scale dependent behavioral responses of snowshoe hare in western conifer forests post-fire, Jenna Hutchen	House Hunters: Petrel edition, Rielle Hoeg	Preliminary results and predictions from a beyond-range field planting experiment of four northern temperate tree species in Newfoundland, Piers Evans		
08:45	Experimental evolution in the wild using long-term ecological experiments to study the evolution of mutualism, Jen Lau		Rapid evolution in silence: Adaptation to the loss of a sexual signal, Marlene Zuk	Where the rubber meets the road: The influence of roads on grizzly bear density, Clayton T. Lamb	Human shields mediate sexual conflict in a top predator, Martin Leclerc	Arctic willow: Probing polar deserts for pockets of nutrients?, Amanda L. Guy	Canada's crossroads for sustainable development and the environment, Aerin Jacob	
09:00	Ocean change, phenotypic plasticity and assisted evolution, Gloria Massamba N'Siala		Aggression and the evolution of color signals in stomatopod crustaceans, Megan Porter	Endangered endemic cyprinid minnow exhibits different spatial and temporal patterns to native and invasive species in a perennial desert stream, Carolyn Trombley	Land-use change and species occupancy in tropical bird communities, Leithen M'Gonigle	Impacts of deciduous and coniferous canopies on moss associated N-fixation: Implications for boreal N-cycling, Melanie Jean	How Haida law embraces traditional and scientific knowledge, Terri-Lynn Williams Davidson	
09:15	Experimental evolution in ecological communities: Predators mediate rapid evolution of herbivores and resources to warming, Michelle Tseng			The impact of mountain pine beetle and mountain pine beetle management on caribou and grizzly bear food supply, Barry R. Nobert	Determining factors affecting dragonfly emergence, including a species-at-risk (skillet clubtail: <i>Gomphus ventricosus</i>) in the lower St John river and Grand Lake meadows area, Zoe O'Malley	Plant functional groups, hydrological conditions and climate interact to affect carbon accumulation in peatlands, Terri Lacourse	Watershed connections in environmental decision-making, Jill Weitz	
09:30	Evolutionary rescue of complex phytoplankton communities exposed to a widespread herbicide, Vincent Fugère		NSERC Update Brenda MacMurrey, How to apply for a Discovery Grant, and DG results.		Why are train strikes on grizzly bears increasing in the mountain parks and what can we do about it?, Colleen Cassady St. Clair	Density-dependent habitat selection predicts fitness and abundance of tree lizards (<i>Urosaurus ornatus</i>), James E. Paterson	Boreal peat properties link to plant functional traits of ecosystem engineers, Julia E. Palozzi	Should courts be 'Academies of Science'? Lessons From the misapplication of "Adaptive Management" under the Canadian Environmental Assessment Act, Martin Olszynski
09:45	Eco-evolutionary simulation models as a way of experimenting evolution, Anna Kuparinen				Tracing the origin of migratory pest species European starling (<i>Sturnus vulgaris</i>): Application of geochemical fingerprinting in south central British Columbia, Canada, K C Upama	Characterizing Dakota skipper (<i>Hesperia dacotae</i>) habitat and distribution in southeastern Saskatchewan, Kelsey M. Seidle	Forest understory changes over 30 years following tephra disturbance at Mount St. Helens, Joseph A. Antos	From fishing gears to fish habitat: Canada's fisheries future depends on evidence-based decision-making, Brett Favaro
Coffee Break 10:00 - 10:30								

Wed							
Room:	Theatre	Saanich	Oak Bay 1	Oak Bay 2	Esquimalt	West Coast	Newcombe RBCM
10:30	Dispersal limitation, climate change, and practical tools for conservation in intensively used landscapes, Laura E. Coristine	NSERC Update Brenda MacMurrey, How to apply for a Discovery Grant, and DG results.	The at-risk yellow-banded bumblebee (<i>Bombus terricola</i>) shows signs of inbreeding and selection for pathogen resistance: Results from population genomics, Clement F. Kent	Mosquito community ecology and malaria transmission, Amber Gigi Hoi	Hierarchical demography in a cooperative breeder, Andrew Bateman	Burning in SpaDES: Automated parameter estimation for landscape fire models, Steve Cumming	*Linking Environmental Law and Science* Accelerating the creation of effective marine protected areas in Canada: scientific advice and the federal Oceans Act, Linda Nowlan
10:45	Gene expression associated with dispersal ability under different temperature conditions in the alpine butterfly, <i>Parnassius smintheus</i> , Maryam Jangjoo		The spatial distribution of central place foraging pollinators in mass-flowering crops, Samuel V. J. Robinson	You're the one: Parasite infectious stages choose the most susceptible host individuals, Janet Koprivnikar	Whole Canadian boreal shield lake food webs flex in response to warming, Timothy J. Bartley	Post-fire soil fungal communities and ecosystem function in Canada's boreal forest, Nicola J. Day	Metabolic performance and fitness-related responses of a tropical freshwater fish (Nile perch; <i>Lates niloticus</i>) to elevated temperatures, Elizabeth Nyboer
11:00	Dispersive bird species are at greater risk than sedentary species when human-caused landscape change is rapid, Amanda E. Martin		An approach to the managed relocation of declining North American bumblebee species under climate change, Catherine Sirois-Delisle	Epidemiological dynamics disrupt Red Queen cycles, Ailene MacPherson	River networks dampen long-term hydrological signals of climate change, Kyle Chezik	Changes in soil carbon stock quantity and stability in response to wildfire events in the southern boreal forest, Catherine M. Dieleman	To eat or thermoregulate? Determinants of home range size and density in <i>Sceloporus jarrovi</i> lizards, Lucy D. Patterson
11:15	Ecology, genetics and conservation units despite gene flow in highly-vagile terrestrial mammals (caribou and wolves), Marco Musiani	When outbreaks collide: Interactions between an invasive beetle and a native defoliator on red spruce, Mallory MacDonnell	Flower depth links tongue length and wing morphology through wing use in a community of prairie bumble bees, Ralph Cartar	Parasitic wasp Sudoku: Field studies of host-parasitoid interactions in an urban forest, Caitlin Mader	Using a space-for-time substitution approach to predict implications of climate change on tropical stream ecosystem function, Therese C. Frauendorf	Assessing the relative utility of mesostigmatid versus oribatid mites as bioindicators of disturbance in forested areas of Alberta, Canada, Matthew Meehan	It's not the heat, it's the humidity: Environmental effects on insect-plant interactions, Mary L. Reid
11:30	How did the chickadee cross the road? Mapping arboreal connectivity in urban landscapes, Dee L. Patriquin	Agent-based scenario models of invasion and movement of the orchard pest <i>Rhagoletis pomonella</i> (Diptera: Tephritidae) within the southern interior of British Columbia, Brian Muselle	Mass-flowering canola crops: Implications for prairie pollinators, Paul Galpern	The relative contribution of direct and environmental transmission in a host-pathogen avian flu model, May Anne Mata	Thermokarst expansion rates and the effects on long-term soil carbon storage in interior Alaska, Natalie J. Zwanenburg	Effects of wildfires on tree establishment in conifer-dominated boreal forests in southern Northwest Territories, Kirsten Reid	Heat wave intensity exacerbates fitness trade-offs in the splash pool copepod, <i>Tigriopus californicus</i> , Matthew R. Siegle
11:45	Morphology and gene expression associated with dispersal capability in mountain pine beetle (<i>Dendroctonus ponderosae</i>), Victor Shegelski	When two invasive species meet: Potential interactions between Asian jumping worms and common buckthorn, Carly Ziter	Past floral resources as a predictor of present bee visits to crops, Jessica Guezenn	The importance of dyadic social ties for pathogen dynamics in a gregarious ungulate, Quinn Webber	Temperature dependence of consumer-resource dynamics is constrained by nutrient limitation, Joey R. Bernhardt	Shore morphology and nearshore forest structure on Islands of BCs Central Coast, Wiebe Nijland	Temperature modulation of biological clock gene expression in a reef building coral, Daniel M. Wuitchik
Lunch 12:00 - 13:30 (on your own)							

Wed

Room: Theatre Saanich Oak Bay 1 Oak Bay 2

13:30

PRESIDENT'S INTRO, CSEE

14:00

CSEE Early Career Award Lecture, Emily Darling

14:30

CSEE Early Career Award Lecture, Sean Anderson

Coffee Break 15:00 - 15:30

Room: Theatre Saanich Oak Bay 1 Oak Bay 2

15:30

-

17:00

CSEE Annual General Meeting

19:00

-

20:30

Banquet

Posters up 08:00 - 18:30 Monday & Tuesday

Poster Session A: Monday 16:00 - 18:15

Poster Session B: Tuesday 16:00 - 18:15